

SCHEDULE "A"  
TO  
BY-LAW NO. 1514 (1992)

AREAS OF THE WORKPLACE WHERE SMOKING IS PERMITTED

<u>LOCATION</u>	<u>AREA OF WORKPLACE</u>
1. Town Hall (20 Pelham Town Square)	See attached Diagram (A1)
2. Pelham Arena (1120 Haist Street)	Manager's Office
3. Works Building (675 Tice Road)	3.78 square metre area at north side of building (See attached Diagram A2)
4. Station #1 (177 Hwy. #20 West)	Training Room
5. Station #2 (792 Welland Road)	Training Room save and except the southerly 8 foot portion

TOWN HALL  
20 PELHAM TOWN SQUARE

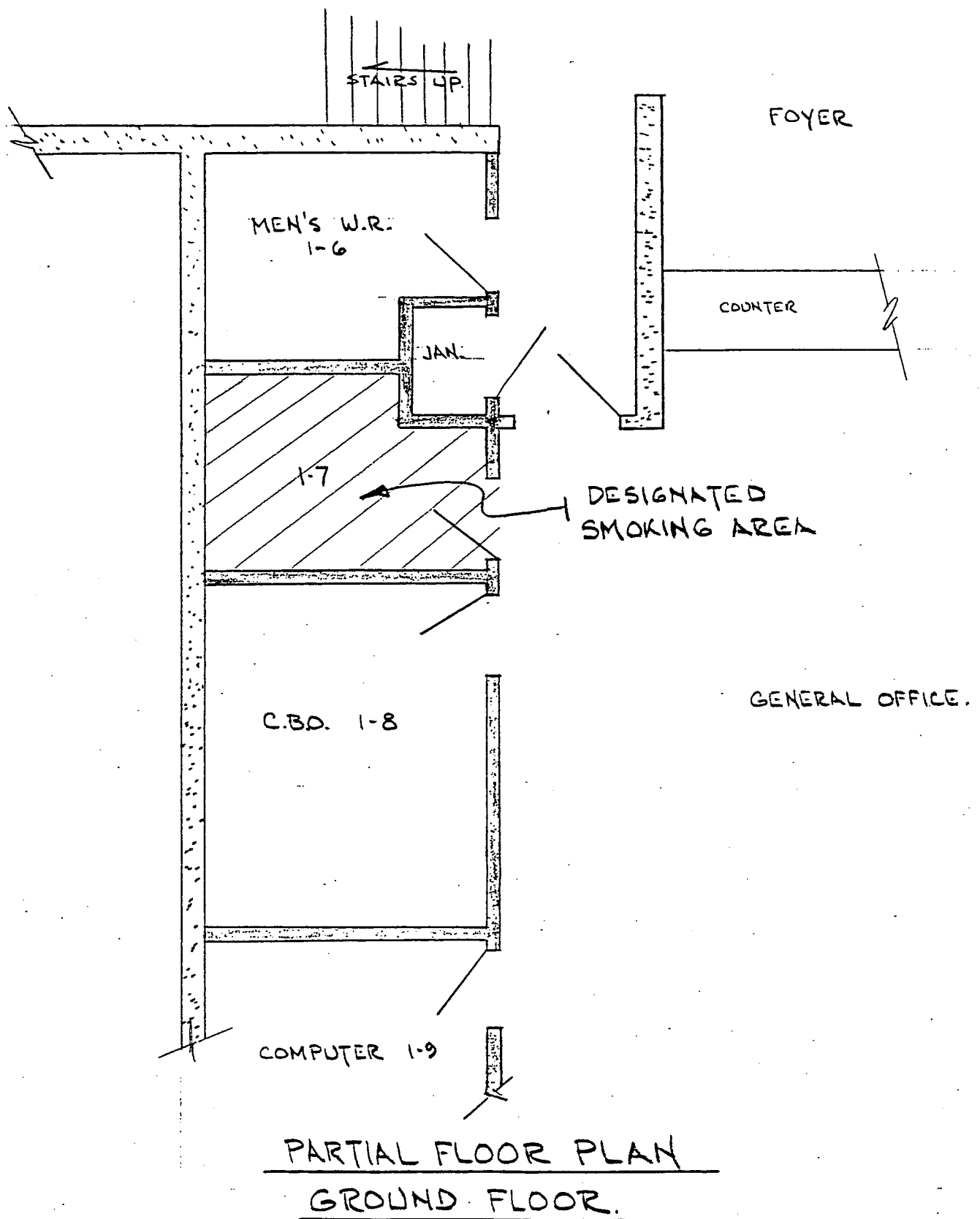

TICE ROAD PUBLIC WORKS BUILDING

